

Explore the property...

Floor Plans



12 Trinity Road  
CH47 2BT

Offers in Excess of £270,000

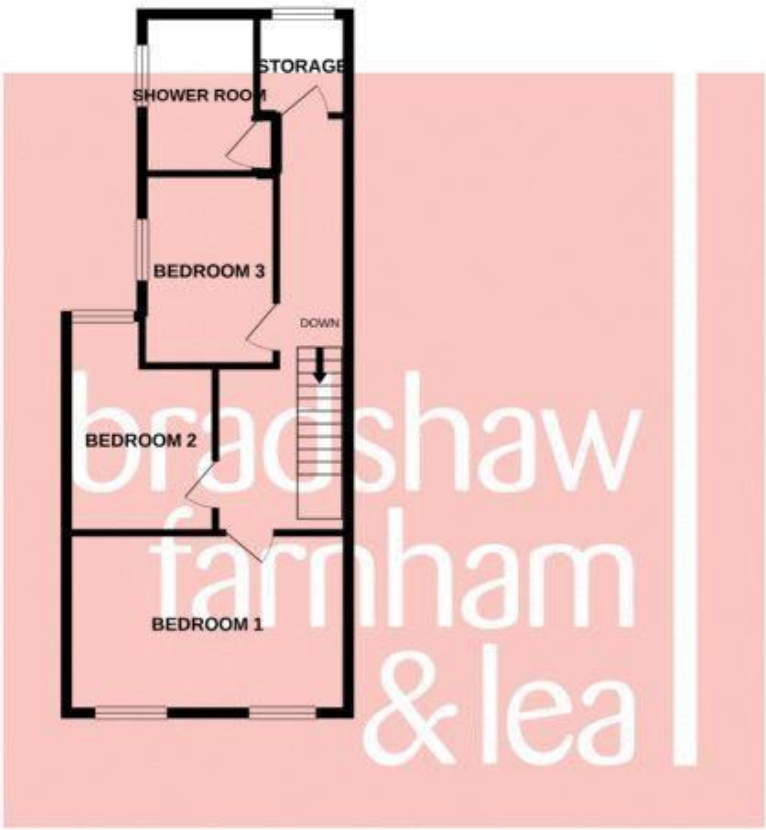
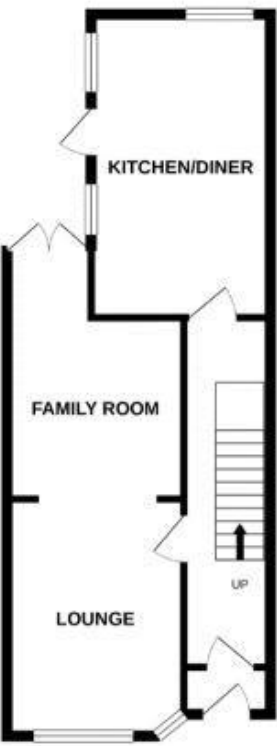

Tenure: Freehold

The Small Print...

Agents Note: These particulars are thought to be correct, though their accuracy cannot be guaranteed and they do not form part of any contract. Please note that we have not tested any apparatus, fixtures, fittings or services and as such cannot verify that they are in working order or fit for their purpose. Furthermore, solicitors should confirm that moveable items described in the sales particulars are, in fact, included in the sale since circumstances do change during marketing or negotiations. A final inspection prior to exchange of contracts is also recommended. Although we try to ensure accuracy, measurements used in this brochure may be approximate. Therefore, if intending purchasers need accurate measurements to order carpeting, or to ensure existing furniture will fit, they should take such measurements themselves.

Contact Bradshaw Farnham & Lea - West Kirby  
Call - 0151 625 8844  
Email - westkirby@bflhomes.co.uk  
Visit - 18 The Crescent West Kirby



- THREE BEDROOMS
- LOG BURNER FIREPLACE
- SPACIOUS ACCOMODATION

- SOUGHT AFTER LOCATION
- SOUTH FACING BEAUTIFUL COURT YARD
- VIEWING HIGHLY RECOMMENDED



About the property...

\*\*\* THREE BEDROOMS\*\*\* PERIOD HOME\*\*\* SOUGHT AFTER HOYLAKE LOCATION \*\*\* VIEWING ESSENTIAL\*\*\* this beautifully presented mid terraced period home offers deceptively spacious living accommodation which should be viewed at the very earliest to fully appreciate all features within. The property comprises in brief of porch, hallway, lounge through to dining room, modern styled dining kitchen with Belling cooker, three well proportioned bedrooms, family shower room and rear courtyard styled garden south facing with sunny aspect. This truly is a delightful home and viewing is highly recommended.

About the location...

From the agent's office proceed right along Market Street and take the first turning on the left after the Punch Bowl public house. The property is situated on the left hand side of the road

